



HOTEL AMIGO
BRUSSELS

A ROCCO FORTE HOTEL



Hotel Amigo
Rue de l'Amigo 1-3
Brussels 1000
Belgium

Telephone +32 2 547 4747
Fax +32 2 513 5277

e: events.amigo@roccofortehotels.com

FOLLOW US

[HotelAmigoBrussels](https://www.facebook.com/HotelAmigoBrussels)

[@RF_HotelAmigo](https://twitter.com/RF_HotelAmigo)

roccofortehotels.com/hotel-amigo/

[hotelamigobrussels](https://www.instagram.com/hotelamigobrussels)

The most luxurious hotel in Brussels, Hotel Amigo is located around the corner from the magnificent Grand Place, offering guests unparalleled service and style. Set amongst historic cobbled streets, the hotel features luxurious, contemporary design embellished with stylish Flemish touches.

Rooms are individual in style and feature surrealist prints by Marcel Broodthaers and René Magritte; some have views of the neighbouring historic buildings - the Town Hall, churches and spires of the city. The new Tintin bedrooms and suite feature prints, characters and collectables from Hergé's famous comic books and will delight fans of all ages. The ballroom features separate access and all meeting rooms are equipped with the latest communications technology.

MEETINGS & EVENTS

- 5 meeting rooms for up to 55 delegates
- Ballroom for up to 300 guests (dividable into 2 separate rooms) with marble foyer and direct access to Town Hall
- 180m² Blaton Suite with a 60m² terrace, available for private events
- 24-hour Business Centre
- All rooms have natural daylight and Wi-Fi access
- 40 parking spaces

OTHER FACILITIES

ACCOMMODATION

- 154 bedrooms
- 19 suites

RESTAURANT & BAR

- BoCConi with terrace
- Bar Amigo

RELAXATION

- The Amigo Fitness Centre

TRANSFERS

- 20 minutes from Brussels International Airport (BRU)
- 10 minutes Midi train station

CONFERENCE AND BANQUETING FACILITIES

Room	Size	lxwxh	Set Up	Capacity	
Hotel Amigo					
Rotonde	56 m ²	7 x 8 x 4 m	Reception	65	
	598 sq ft	23 x 26 x 13 ft	Seated Dinner	40	
Ambassadeur A	76 m ²	9 x 8,5 x 4 m	Reception	80	
			Seated Dinner	50	
	Classroom	45			
	Theatre	60			
	U-Shape	24			
	Cabaret	35			
	Boardroom	24			
Ambassadeur B	112 m ²	12,5 x 9 x 4 m	Reception	85	
			Seated Dinner	45	
	Classroom	40			
	Theatre	40			
	U-Shape	18			
	Cabaret	25			
	Boardroom	18			
Ambassadeurs A+B	188 m ²	18 x 12,5 x 4 m	Reception	200	
			Seated Dinner	120	
	Classroom	100			
	Cabaret	60			
	Theatre	120			
	U-Shape	45			
	Boardroom	45			
	Ambassadeurs A+B + Rotonde	244 m ²		Reception	250
		2,625ft ²		Seated Dinner	160
	Hankar	20 m ²	5 x 4 m	Boardroom	10
221 sq ft		17 x 13 x 7 ft	Seated Dinner	10	
Van de Velde	51,5 m ²	14 x 3,7 m	Reception	30	
	552 sq ft	46 x 12 x 8 ft	Seated Dinner	20	
Horta	76 m ²	13,7 x 5,6 m	Theatre	30	
			Boardroom	20	
	Reception	60			
	Seated Dinner	45			
	Classroom	34			
	Cabaret	30			
Brel	22,5m ²	4,5x5m	Theatre	50	
			U-Shape	26	
	Boardroom	26			
	Boardroom	10			
	Seated Dinner	10			
	Hergé A	27,5 m ²	5,5 x 5 m	Reception	15
	294 sq ft	15 x 16 x 8 ft	Seated Dinner	12	
			Classroom	8	
Hergé B	22,5 m ²	4,5 x 5 m	Theatre	15	
			Boardroom	12	
	Reception	15			
	Seated Dinner	12			
	Classroom	8			
	Cabaret	12			
Hergé A+B	50m ²	10 x 5 m	Boardroom	12	
			Reception	40	
	Seated Dinner	32			
	Classroom	24			
	Cabaret	18			
	Theatre	30			
	561 sq ft	33 x 17 x 9,5 ft	U-Shape	18	
			Boardroom	20	

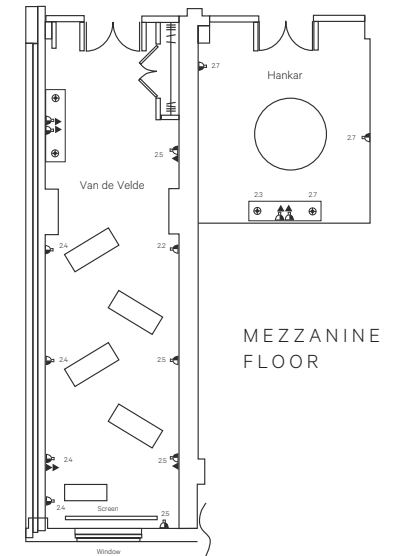
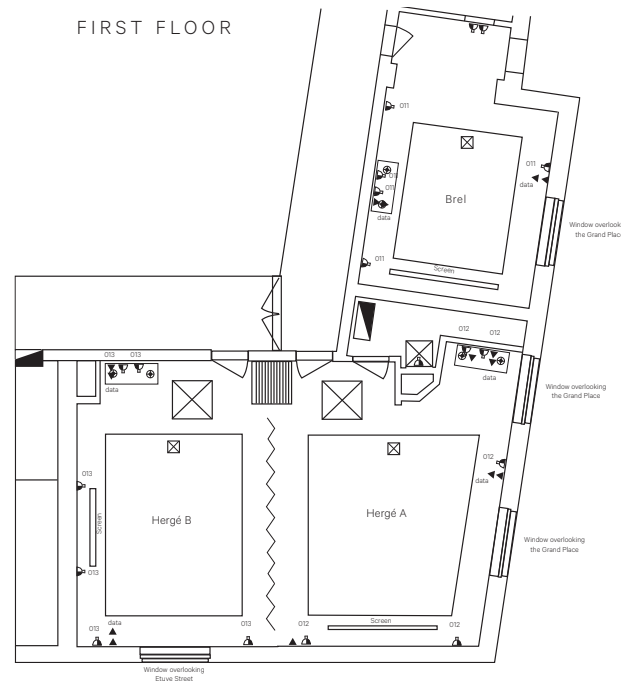
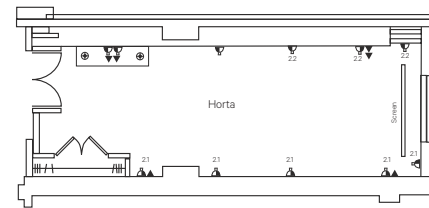
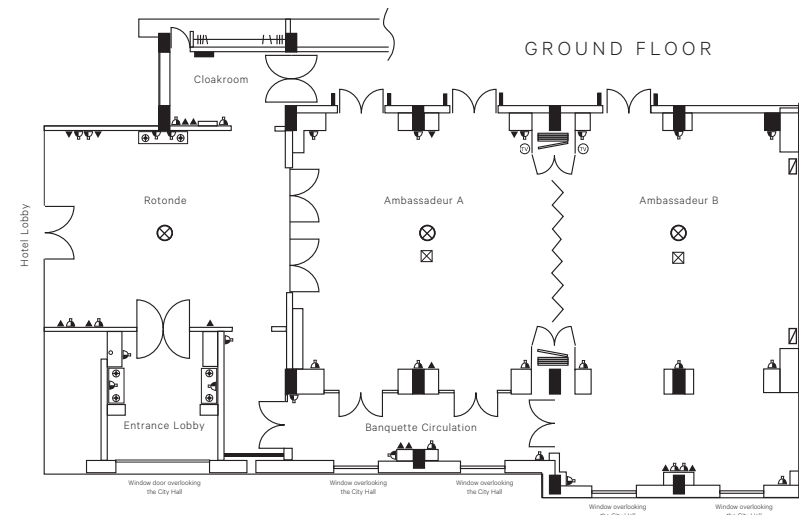

FOR MORE INFORMATION PLEASE VISIT
ROCCOFORTEHOTELS.COM

**ROCCO FORTE
HOTELS**

